

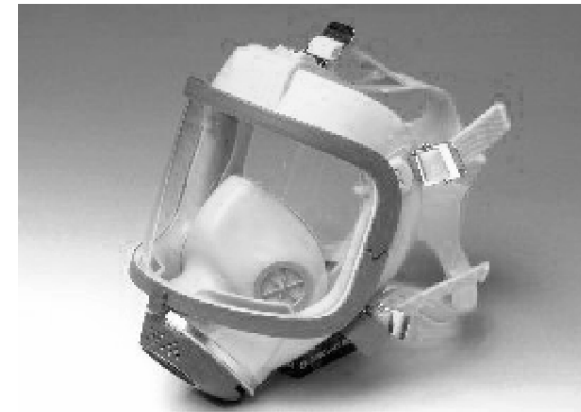

# SEA Full Face Mask Insert SEA-FI

Insert recommended for improving face seal when a face seal is difficult to achieve



## Safety Equipment America Inc.

20 North Blossom Street,  
East Providence, RI 02914  
USA

Toll Free: 888-732-3500

Email:  
[sea.america@theseagroup.com](mailto:sea.america@theseagroup.com)

## Safety Equipment Europe AB

Storgatan 64  
S-331 31 Värnamo, Sweden

Ph: [+46] (0)370 460 40  
Fax: [+46] (0)370 17979

Email:  
[sea.europe@theseagroup.com](mailto:sea.europe@theseagroup.com)

## Safety Equipment Australia Pty Ltd.

35/1 Jubilee Avenue  
Warriewood, NSW, 2102,  
Australia

Ph: [+61] (0)2 9910 7500  
Fax: [+1] (0)2 9979 5364  
Toll Free: 1800-655-129

Email:  
[sea.australia@theseagroup.com](mailto:sea.australia@theseagroup.com)

**[www.theseagroup.com](http://www.theseagroup.com)**

Rev C per CN1010

## User Instructions

100287-03 C  
4Dec07

## S.E.A. Full Face Mask Foam Insert *SEA-FI*

The S.E.A. full face mask comes in a single size to fit a wide range of face sizes and shapes. The SEA-FI foam insert is intended for those users with small or unusual facial features who have difficulty achieving a good face seal with the S.E.A. full face mask.

The SEA-FI foam insert may be used with the following S.E.A. respirators: S.E.A. Full Face Masks (FS, FP, FC and FN), SE400 range of positive pressure demand PAPRs, SE40 positive pressure demand CBRN PAPR and FP-C CBRN APR. All of these respirators have the same face seal.

### FACEPIECE FIT TESTING

Before issuing a respirator to a user, quantitative facepiece fit testing (QNFT) should be used as follows:

1. to assess the quality of the face seal for each user
2. if poor face sealing is identified, to verify that a satisfactory face seal can be achieved with the SEA-FI foam insert fitted

For detailed facepiece fit testing instructions refer to the respirator user instructions.

### INSTALLATION

**Note:** The SEA-FI foam insert should be issued only to users who have been fit-tested as above.

To fit the foam insert:

1. Pull the head harness to the front of the visor to give clear access to the face seal
2. Peel back the foam insert's adhesive backing strip to just over half way (marked by a white dot)
3. Folding back the top of the face seal, align the white dot with the top centre of the facepiece. The bevelled edge of the foam insert should be visible and facing towards the face seal
4. Press the centre of the foam insert onto the mask body, aligning the bevelled edge of the foam insert with the crease in the mask body
5. Working around the mask to one side, press the foam insert onto the mask body, aligning it with the crease all the way
6. Peel away the rest of the adhesive backing and fit the other side of the insert in the same way. The shaded area in Figure 6 shows correct location of foam insert (under the face seal)

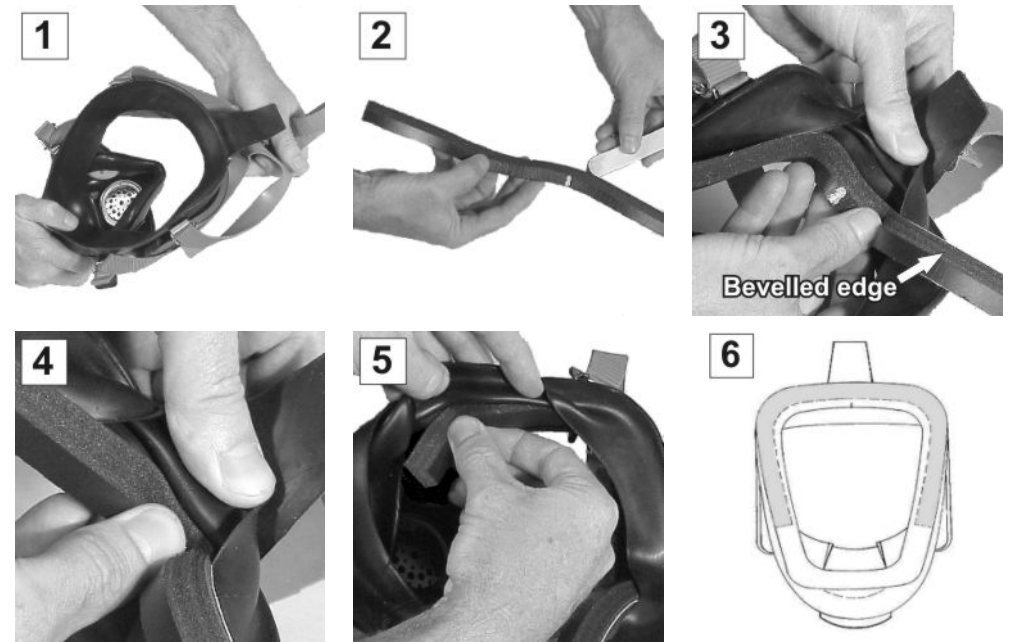

### CLEANING AND MAINTENANCE

1. Clean and disinfect the mask according to the standard S.E.A. Operating Instructions.
2. After washing, check insert for adhesion around perimeter of face seal. NOTE: If foam insert is pulling loose or adhesive bond is broken, replace with a new insert.

**Note:** When fitting the foam insert to a silicone rubber facepiece the silicone adhering surface should be prepared with a silicone primer. Apply primer with a lint-free cloth and allow to dry. S.E.A. recommends PECORA P-120 primer, supplied by Kenseal Construction Products. Go to [www.kenseal.com](http://www.kenseal.com)