

# Sundström

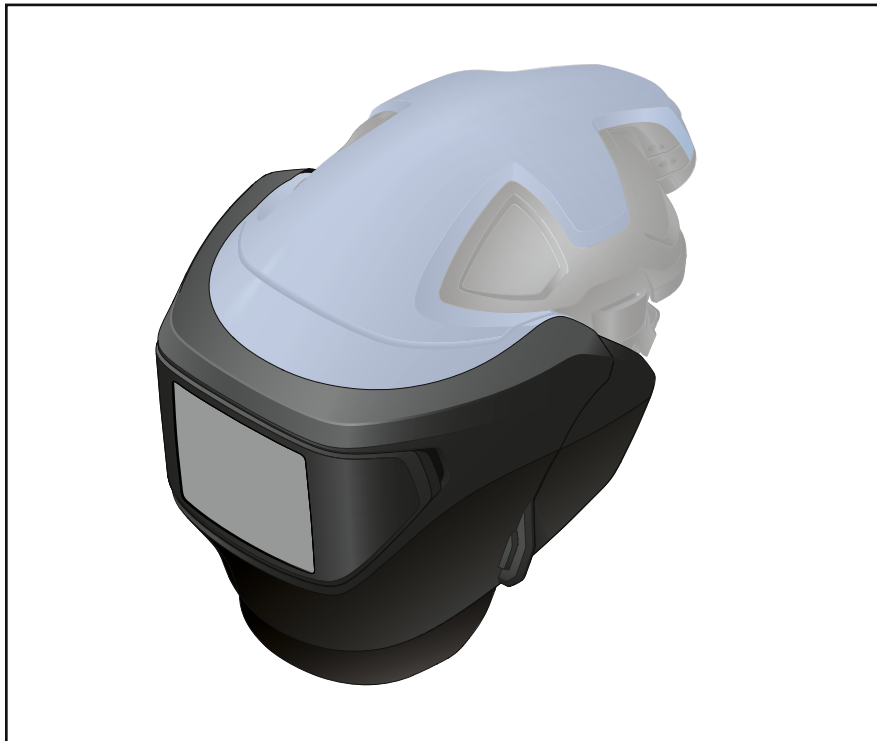

## SR 574

T06-0613, Welding shield

ИНСТРУКЦИИ ЗА УПОТРЕБА • NÁVOD K POUŽITÍ • BRUGSANVISNING  
• GEBRAUCHSANLEITUNG • ΟΔΗΓΙΕΣ ΧΡΗΣΗΣ • USER INSTRUCTION  
• INSTRUCCIONES DE USO • KASUTUSJUHEND • KÄYTTÖOHJEET •  
CONSIGNES D'UTILISATION • HASZNÁLATI UTASÍTÁS • ISTRUZIONI PER  
L'USO • LIETOŠANAS INSTRUKCIJAS • NAUDOJIMO INSTRUKCIJOS •  
GEBRUIKSAANWIJZING • BRUKSANVISNING • INSTRUKCJA UŻYTKOWANIA •  
INSTRUÇÕES DE UTILIZAÇÃO • INSTRUȚIUNI DE UTILIZARE • РУКОВОДСТВО  
ПО ИСПОЛЬЗОВАНИЮ • NÁVOD NA POUŽITIE • NAVODILA ZA UPORABO •  
BRUKSANVISNING • KULLANIM TALİMATLARI

1. General information
2. Parts
3. Use
4. Maintenance
5. Technical specifications
6. Key to symbols
7. Approval

## 1. General information

### 1.1 System description

The Sundström SR 574 welding shield is intended for use together with the Sundström SR 570 face shield and with the Sundströms battery-powered fan SR 500/SR 700.

### 1.2 Applications

The SR 574 in combination with the SR 570 and fan is designed specifically for protection against particles, harmful gases, radiation and spatter during welding, flame cutting, grinding and similar work.

### 1.3 Warnings Limitations

#### Warnings

- Change the welding filter immediately if it is found to be damaged.
- Materials that come into contact with the user's skin may give rise to allergic reactions if the user is sensitive.
- The welding shield must be fully lowered while work is in progress.
- If the welding shield is equipped with a toughened mineral glass filter, a protective lens (item 9 in 2. *Parts*) should be fitted on the inside of the toughened mineral glass filter.
- Damaged or scratched protective lens must immediately be replaced.

#### Limitations

- Check that the welding filter have the correct shade number for your work.
- The welding shield must always be fitted with a protective lens in addition to the welding filter.
- Always observe the fire safety rules.

## 2. Parts

Fig. 31.

#### Description

1. Valve cover SR 574
2. Ear cover, right+left
3. Protective lens holder
4. Fixation/lower mechanism complete, right+left
5. Spring for welding filter
6. Welding filter, shade No. 8, SR 59008
6. Welding filter, shade No. 9, SR 59009
6. Welding filter, shade No. 10, SR 59010
6. Welding filter, shade No. 11, SR 59011
6. Welding filter, shade No. 12, SR 59012
6. Welding filter, shade No. 13, SR 59013
7. Welding filter, EN 3/10, SR 59005
7. Welding filter, EN 3/11, SR 59006
7. Welding filter, EN 4/9-13, SR 59007
7. Welding filter, EN 4/5-13
8. Inner protective lens for auto filter
8. Inner protective lens for R06-4508

#### Ordering No.

- R06-0484
- R06-0483
- R06-0479
- R06-0621
- R06-0622
- T06-4001
- T06-4002
- T06-4003
- T06-4004
- T06-4005
- T06-4006
- T06-4007
- T06-4008
- T06-4009
- R06-4508
- R06-4009
- R06-4509

9. Inner protective lens for toughened mineral glass filter R06-4008
10. Correction lens, dptr 1,0, SR 59014 T06-4010
10. Correction lens, dptr 1,5, SR 59015 T06-4011
10. Correction lens, dptr 2,0, SR 59016 T06-4012
10. Correction lens, dptr 2,5, SR 59017 T06-4013
11. Protective lens PC R06-4008
12. Bump cap T06-0602
13. Face seal, flame retardant T06-0611
14. Neck cover, flame retardant T06-0610
- Note! T06-0602 is required
15. Protective hood T06-4014
16. Protective hose for the breathing hose T06-4016
17. Cleaning wipes SR 5226, box of 50 H09-0401

## 3. Use

### 3.1 To fit the welding shield on the face shield

- Release and remove the visor. Fig. 1.
- Release and remove the vent cover SR 570. Fig. 2, 3.
- Fit the vent cover SR 574. Fig. 4, 5.
- Fit the visor back. Fig. 6, 7, 8, 9.
- Release and remove the covers. Fig. 10.
- Release and remove the ear covers. Fig. 11.
- Turn the brackets on the welding shield. Fig. 12.
- Fit the welding shield. Fig. 13, 14.
- Fit the ear covers back. Fig. 15.
- The welding shield can be raised in two positions. Fig. 16.  
Position A for short-term raising.  
Position B for locking-position.

### Hearing protectors

It is possible to attach hearing protectors into the slot connection on the sides of the face shield when the ear covers are removed. Fig. 17.

### 3.2 To remove the welding shield

Remove the welding shield. Fig. 18.

### 3.3 Welding filter

For replacement of welding filter. See 4.3.3.

### 3.4 Donning/Doffing the face shield

Follow the directives in the user instructions for the SR 570 face shield.

## 4. Maintenance

The person responsible for cleaning and maintaining the equipment must have suitable training and be well acquainted with work of this type.

### 4.1 Cleaning

Clean welding visor and glass with Sundström SR 5226 cleaning wipes or with a mild soap solution.

If necessary, spray the welding shield with 70 % ethanol or isopropanol solution for disinfection.

**NOTE! Never use a solvent for cleaning!**

### 4.2 Storage

After cleaning, the equipment should be stored in a dry and clean location at room temperature. Avoid direct sunlight. The welding shield is not affected by an extended period of storage.

## 4.3 Changing parts

### 4.3.1 To change the protective lens holder

- Remove the old protective lens holder. Fig. 19, 20.
- Fit a new protective lens holder. Fig. 21, 22.

### 4.3.2 To change the protective lens

The lens must be CE marked and of standard 90x110 mm size.

- Remove the old protective lens. Fig. 23.
- Fit a new protective lens. Fig. 24.

### 4.3.3 To change the welding filter

The welding filter must be CE marked and of standard 90x110 mm size.

- Remove the old welding filter. Fig. 25, 26.
- Fit a new welding filter. Fig. 27, 28, 29.

Make sure that the welding filter is firmly attached. Depending on the thickness of the welding filter, there are two options for tensioning the spring. Fig. 29.

### 4.3.4 Fitting the correction lens

- Place the correction lens on the inside of the welding filter. Fig. 30.

## 5. Technical specifications

### Temperature range

- Storage temperature: from -20 °C to +40 °C at a relative humidity below 90 %.
- Service temperature: from -10 °C to +55 °C at a relative humidity below 90 %.

### Shelf life

The equipment has a shelf life of 5 years from the date of manufacture.

## 6. Key to symbols



See user instructions



Date clocks, year and month



CE approved by  
INSPEC International B.V.



Relative humidity



Temperature range

## 7. Approval

The SR 574 is approved in accordance with EN 175:1997.

Marked: EN 175 S.

S = increased robustness.

The PPE Regulation (EU) 2016/425 type approval has been issued by Notified Body 2849. For the address, see the reverse side of the user instructions.

The EU declaration of conformity is available at [www.srsafety.com](http://www.srsafety.com)

### UKCA

UKCA Type-examination by UK Approved Body No 0194, INSPEC International Ltd, 56 Leslie Hough Way, Salford, Greater Manchester, M6 6AJ, United Kingdom.

The UKCA declaration of conformity is available at [www.srsafety.com](http://www.srsafety.com)

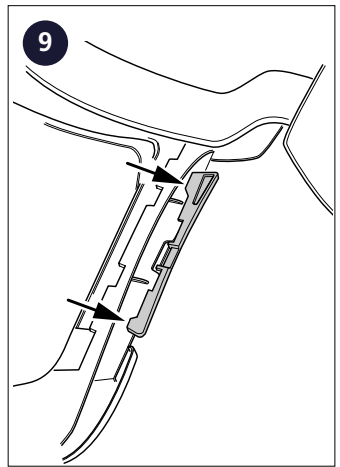
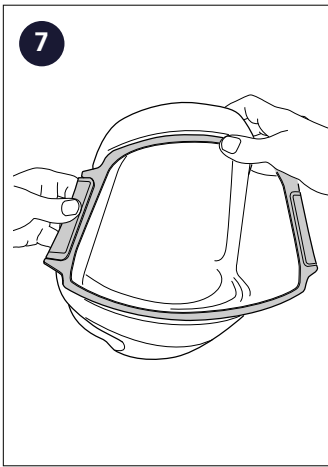
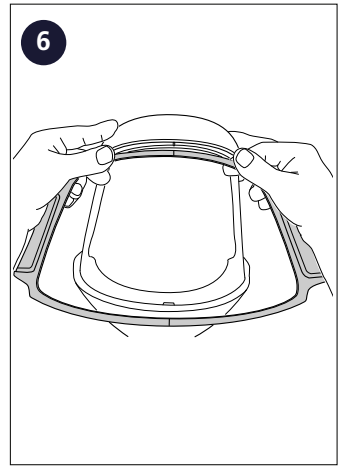
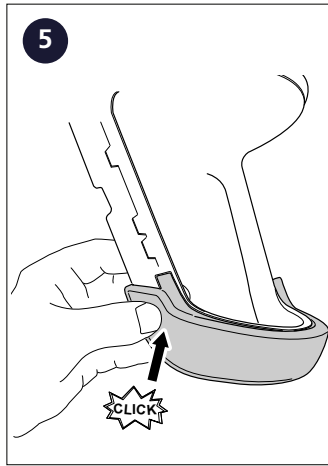
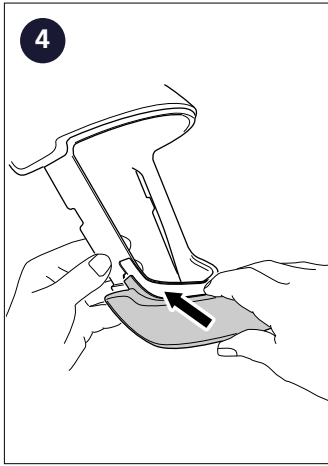
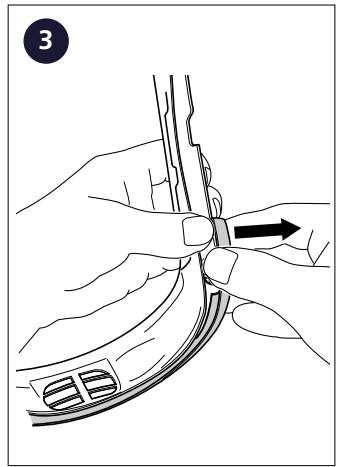
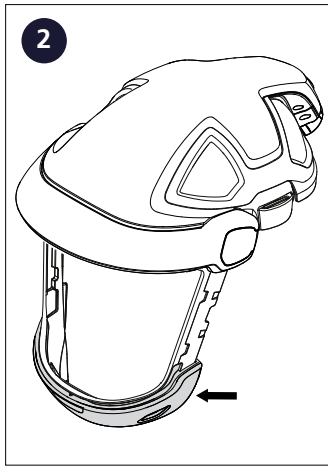
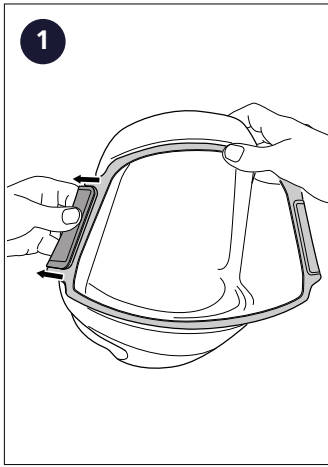

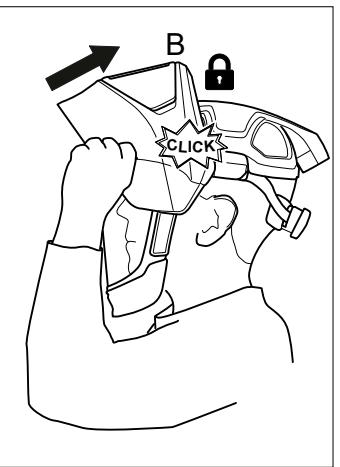
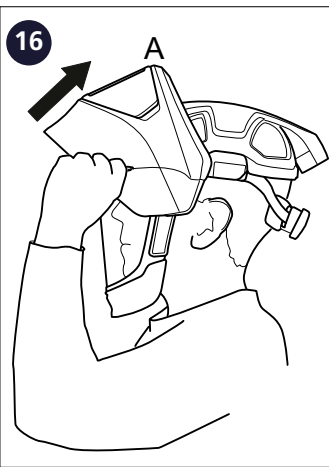
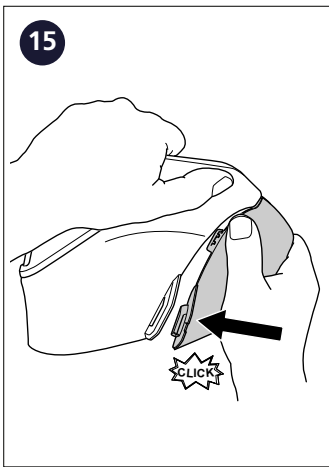
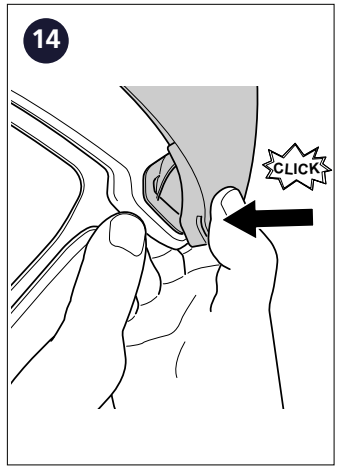
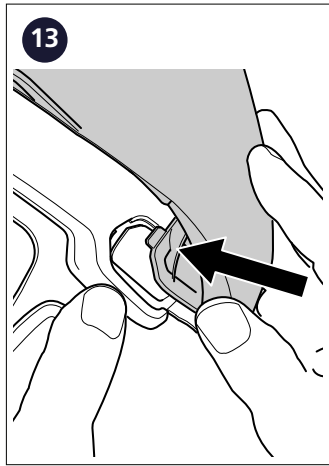
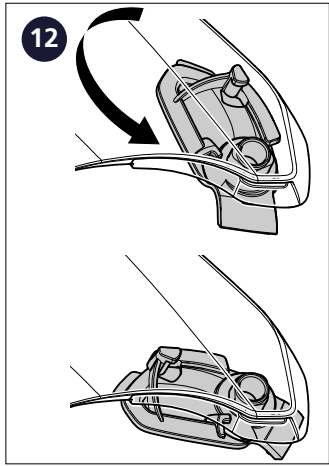
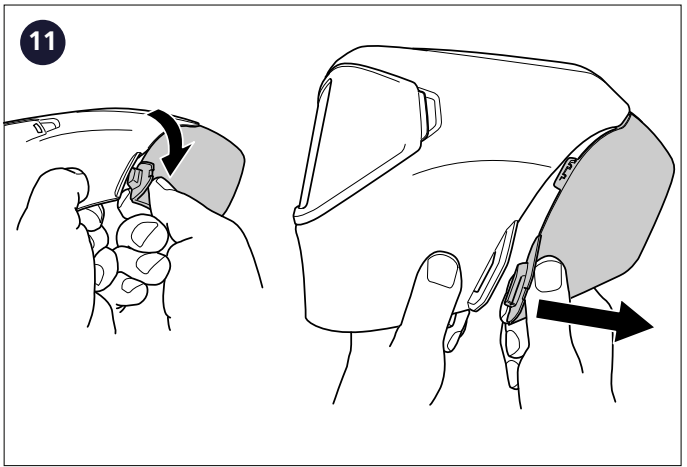
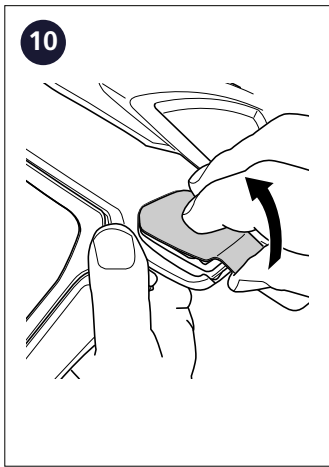

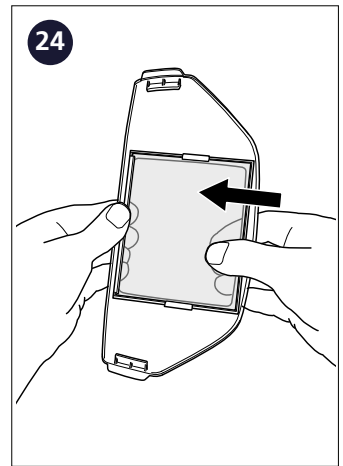
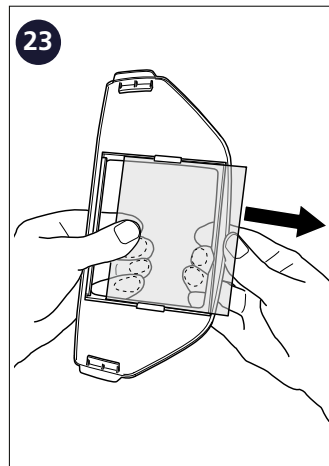
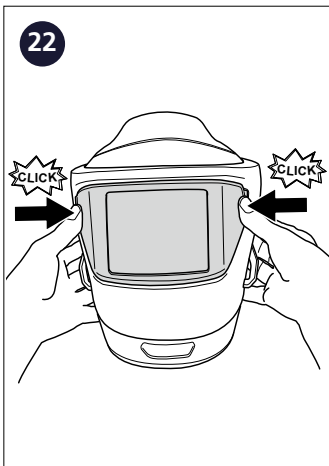
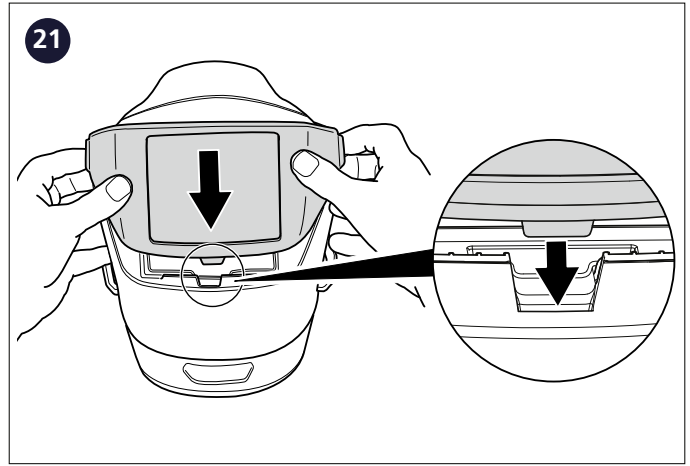
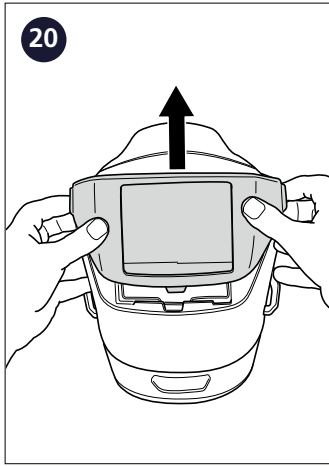
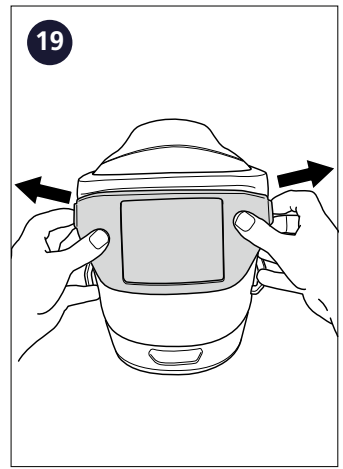
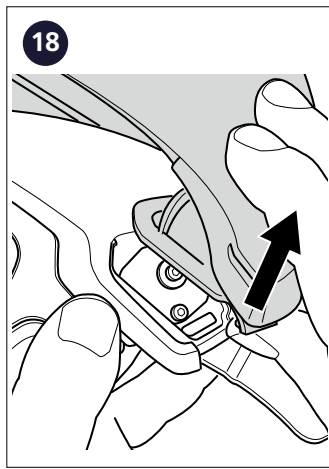
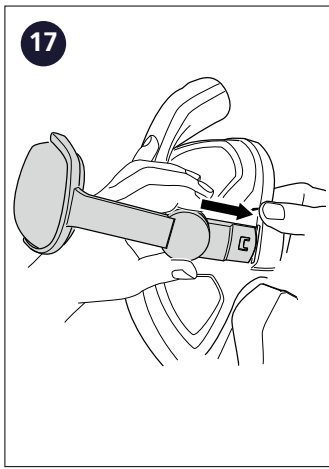

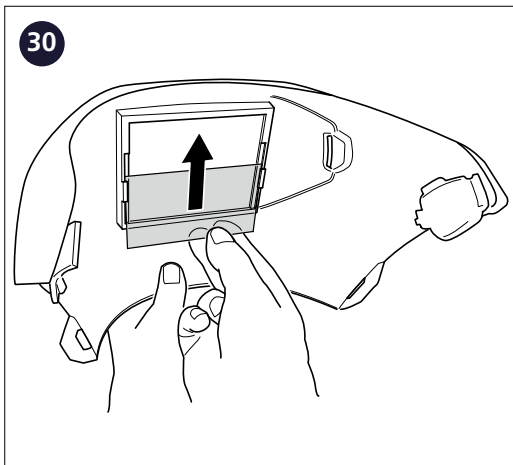
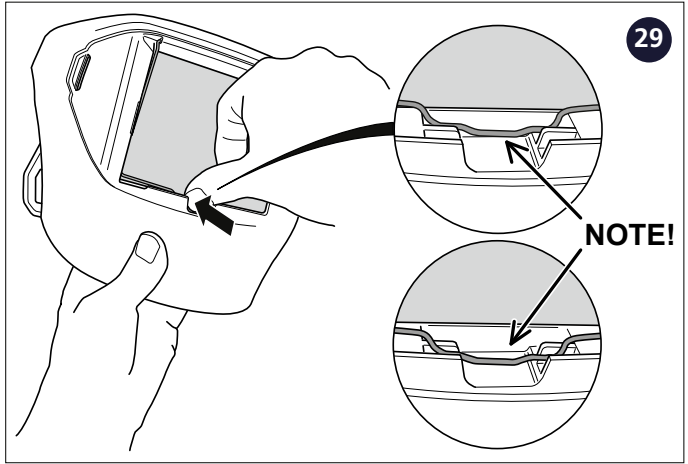
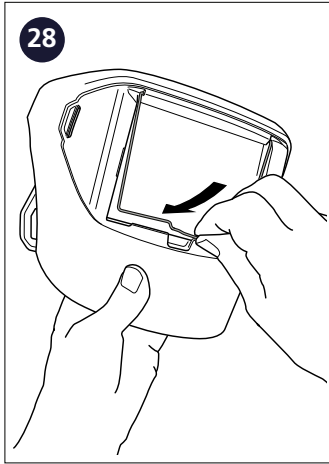
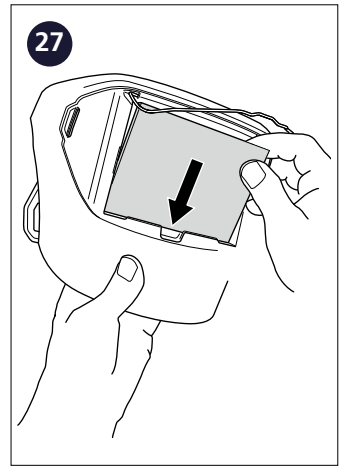
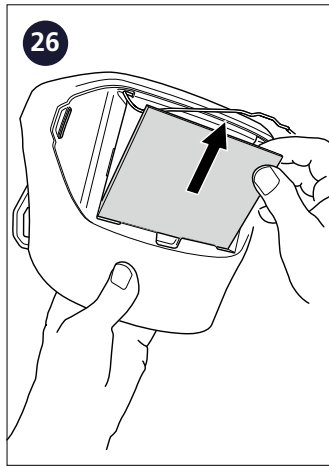
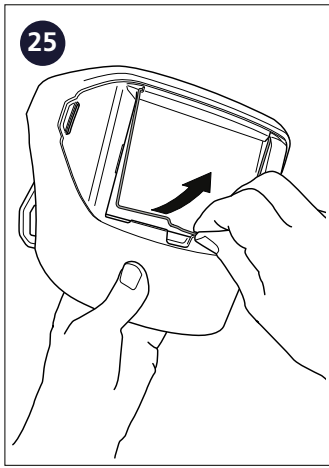

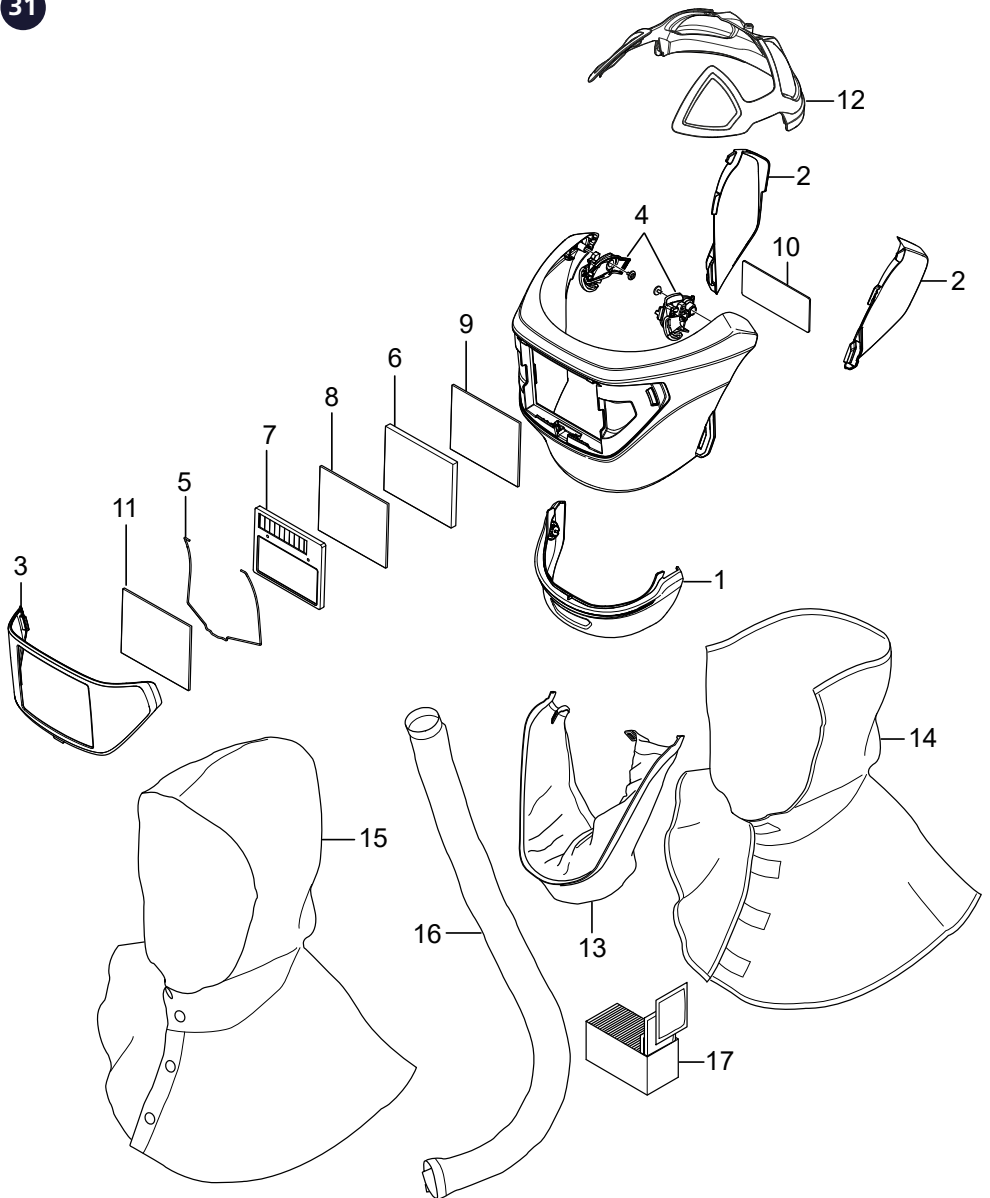





**The Welding Shield SR 574 is manufactured within a  
quality management system accepted by  
Notified Body 2849: INSPEC International B.V.,  
Beechavenue 54-62, 1119 PW,  
Schiphol-Rijk, The Netherlands**



**Sundström Safety AB**  
SE-341 50 Lagan • Sweden  
Tel: +46 10 484 87 00  
info@srsafety.se • www.srsafety.com