



## SR 76-3, SR 77-3

ИНСТРУКЦИИ ЗА ПОТРЕБИТЕЛЯ • NÁVOD PRO UŽIVATELE •  
BRUGSANVISNING • GEBRAUCHSANLEITUNG • ΟΔΗΓΙΕΣ ΧΡΗΣΗΣ  
• USER INSTRUCTIONS • MANUAL DE INSTRUCCIONES •  
KASUTUSJUHEND • KÄYTTÖOHJEET • NOTICE D'UTILISATION •  
FELHASZNÁLÓI ÚTMUTATÓ • ISTRUZIONI PER L'USO • NAUDOJIMO  
INSTRUKCIJOS • LIETOTĀJA INSTRUKCIJA • GEBRUIKSAANWIJZING  
• BRUKSANVISNING • INSTRUKCJA UŻYTKOWNIKA • INSTRUÇÕES  
DE UTILIZAÇÃO • INSTRUCTIUNI DE UTILIZARE • РУКОВОДСТВО  
ПОЛЬЗОВАТЕЛЯ • NÁVOD NA POUŽÍVANIE • NAVODILA ZA UPORABO  
• BRUKSANVISNING • KULLANIM TALİMATLARI

## SR 76-3, SR 77-3 Escape Hoods

### 1. Intended use

The escape hood **SR 76-3 Chem** is designed for use as respirator during evacuation in the event of chemical emission accidents. The hood is designed only as an escape hood for single use and provides protection only if the surrounding air has a normal oxygen content, 17–21 %. Maximum time of use: 30 minutes.

The escape hood **SR 77-3 Smoke** is designed for use as respirator during evacuation in the event of a fire or chemical emission accidents. The hood is designed only as an escape hood for single use and provides protection only if the surrounding air has a normal oxygen content, 17–21 %. Maximum time of use: 30 minutes.

### 2. Safety



#### **Warning!**

The hood will not provide the intended protection if the aluminum bag has been damaged so that the vacuum has been lost. If the vacuum is lost, the hood shall be discarded.



#### **Warning!**

The hood does not give full protection to children or persons with unusual face size, beard growth or deep facial furrows. This because the escape hood get a worsening fit.



#### **Warning!**

Earrings/piercings can damage the neck seal at donning.



#### **Warning!**

Be aware that flames or liquid metal droplets may ignite the charcoal in the filter, which may result in acute levels of toxic substances.



#### **Warning!**

Oxygen or oxygen enriched air shall not be supplied the hood.



#### **Warning!**

The Chem SR 76-3 escape hood do not provide protection against propenal (acrolein), hydrogen chloride (HCl), hydrogen cyanide (HCN) and carbon monoxide (CO).



#### **Warning!**

The shelf life of the hood may be reduced if it's not handled and stored as directed.

#### **Important!**

The hood must be carefully handled and protected from blows, shocks and crushing injuries.

### 3. Description

The escape hood is based on the Sundström SR 100 half mask mounted in a flame-retardant and chemicals resistant material.

The hood can be put on quickly and simply, without prior adjustment. The hood is available in two sizes that will fit most adults and teenagers. The hood is vacuum-packed in an aluminum bag.

The hood is available in two models:

**Model S** is stationary.

**Model M** is mobile and is supplied in a handy nylon emergency case which can be secured to the user's belt, for example.

**SR 76-3 Chem:** The hood is equipped as standard with the ABEK1-Hg-P3 combination filter, and provides protection against the toxic gases and particles that may be emitted in accidents involving chemicals. The hood can be supplied with other filters from the standard Sundström range. The actual configuration is shown on the packaging label.

**SR 77-3 Smoke:** The hood is equipped with the ABEK1-CO gas filter and the class P3 particle filter, and provides protection against carbon monoxide and other toxic gases, and against particles that may be emitted in a fire or in chemical emission accidents.

**Type A1** provides protection against organic gases and vapours, such as solvents, the boiling points of which are higher than +65 °C.

**Type B1** provides protection against inorganic gases and vapours, such as chlorine, hydrogen sulphide and prussic acid.

**Type E1** provides protection against acid gases and vapours, such as sulphur dioxide and hydrogen fluoride.

**Type K1** provides protection against ammonia and certain amines, such as ethylene diamine.

**Type Hg** provides protection against mercury vapour.

**Type P3** provides protection against all types of particles, both solid and liquid.

**Type CO** provides protection against carbon monoxide.

#### 4. To put the hood on

- 1) Tear up the aluminum bag at the red tear marking. Fig.1.
- 2) Fold out the hood and remove the cover for the visor and the absorber. Fig. 2.
- 3) Put the hood on.  
Alt. 1. Pull it over your head from above. Fig. 3.  
Alt. 2. Place the neckseal under your chin and pull the hood back over your head. Fig. 4. Suitable for persons with long hair or wearing glasses.
- 4) If necessary, adjust the hood so that the mask seals against your face and the neckseal seals against your neck. Fig. 5.

#### 5. Handling and storage

##### **Important!**

Handle your escape hood with the greatest care! Fig. 6.

##### **Model S (Stationary)**

Intended for stationary storage in a clean and dry environment. Storage eg at the workplace, in a cabinet or closet.

##### **Model M (Mobile)**

Intended to be carried during work eg attached to the user's belt or stored in a work vehicle. To maintain optimal function of your equipment, you must handle it carefully and protect it from blows, shocks and crushing injuries.

**NOTE!** Remember to keep the escape hood easily accessible.

#### 6. Inspection

Check that the aluminum bag has not been damaged so that the vacuum has been lost.

The aluminum bag shall fit tight around the escape hood. Fig 7.

1) Check the aluminum bag visually. Fig. 8.  
*If it is not possible to decide visually, proceed to step 2.*

2) Gently pull the aluminum bag. Fig. 9.

Model M should be examined without lifting the bag from the nylon emergency bag.

In case of uncertainty - recheck the aluminum bag on a calibrated scale. The weight may not be increased more than maximum 2.0 grams compared to the starting weight standing on the aluminum bag.

	Clamped, exposed for blows or shocks	Before each work shift	Every 3rd month
Model M	●	●	
Model S	●		●

**NOTE!** When the escape hood has been clamped or exposed for blows or shocks, the check shall be performed first 8 hours after damage.

#### 7. Shelf life

Temperature	Relative humidity	Shelf life
-20 - +55 °C	< 90 %	10 year

#### 8. Approvals

**SR 76-3 Chem** have been tested and approved in two variants in accordance with Technical Specifications based on EN 403:2004 excluding Clause 6.11, gas capacity against propenal (acrolein), hydrogen chloride (HCl), hydrogen cyanide (HCN) and carbon monoxide (CO).

- SR 76-3 S which is intended for stationary storage.
- SR 76-3 M which is also approved as a portable escape hood.

The filters of the hood have been tested and approved in accordance with EN 14387 (gas filter) and EN 143:2000 (particle filter). SR 76-3 Chem is CE labelled.

**SR 77-3 Smoke** have been tested and approved in two variants in accordance with Technical Specifications based on EN 403:2004 and EN 14387:

- SR 77-3 S which is intended for stationary storage.
- SR 77-3 M which is also approved as a portable escape hood.

SR 77-3 Smoke is CE labelled.

The PPE Regulation (EU) 2016/425 type approval has been issued by NotifiedBody No. 2849. For address, see the reverse side of the user instructions.

The EU Declaration of Conformity is available at [www.srsafety.com](http://www.srsafety.com).

#### UKCA

UKCA Type-examination by UK Approved Body No 0194, INSPEC International Ltd, 56 Leslie Hough Way, Salford, Greater Manchester, M6 6AJ, United Kingdom.

The UKCA declaration of conformity is available at [www.srsafety.com](http://www.srsafety.com)

#### The Australian StandardsMark

The escape hoods SR 76-3 and SR 77-3 are tested and certified to comply to AS/NZS 1716:2012. For advice, see also AS/NZS 1715:2009 Use and Maintenance of Respiratory Equipment.

The StandardsMark is issued under licence by SAI Global Certification Services Pty Limited Lic No.766 (ACN 108 716 669) ("SAI Global").

## 9. Label symbols



See user instruction



Production date



Use-by date



**<90% RH**  
Max. ambient relative humidity during operation and storage

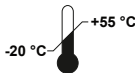

Temperature range during operation and storage



Handle with care



Vacuum



No vacuum



Do not clamp



Do not drop



Do not step



Keep dry

## 9. Etiket sembolleri



Kullanım talimatına  
bakın



Üretim tarihi



Ezmeyin



Düşürmeyin



Son kullanım tarihi



<90% RH

Çalışma ve de-  
polama sırasında  
maks. ortam bağıl  
nemi



Üzerine basmayın



Kuru tutun

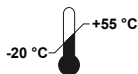

Çalışma ve depo-  
lama sırasında  
sıcaklık aralığı



Dikkatli kullanın



Vakum



Vakum yok

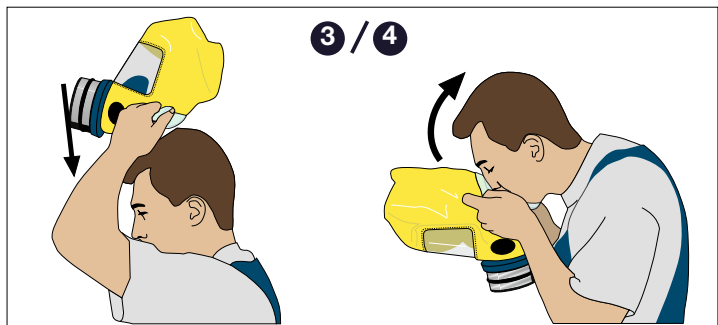
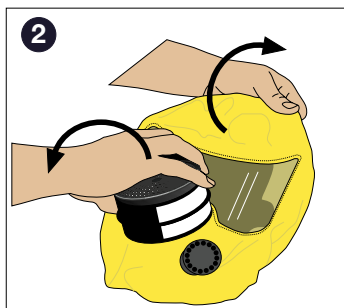
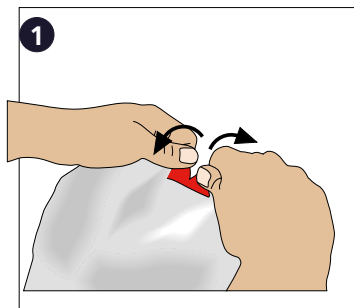

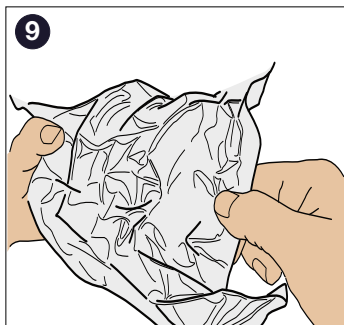
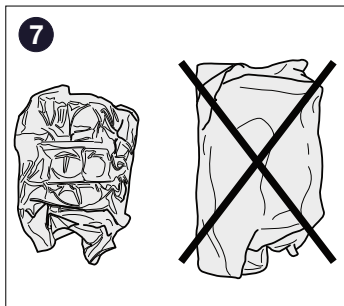

## Vacuum check

[illegible]

## Vacuum check

[illegible]

## Vacuum check

[illegible]

## Vacuum check

[illegible]

## Vacuum check

[illegible]

## Vacuum check

[illegible]



**The SR 76-3 Chem Hoods and the SR 77-3 Smoke Hoods  
are manufactured within a quality management  
system accepted by Notified Body 2849:  
INSPEC International B.V.,  
Beechavenue 54-62, 1119 PW,  
Schiphol-Rijk, The Netherlands.**



**Sundström Safety AB**

SE-341 50 Lagan • Sweden

Tel: +46 10 484 87 00

info@srsafety.se • [www.srsafety.com](http://www.srsafety.com)